

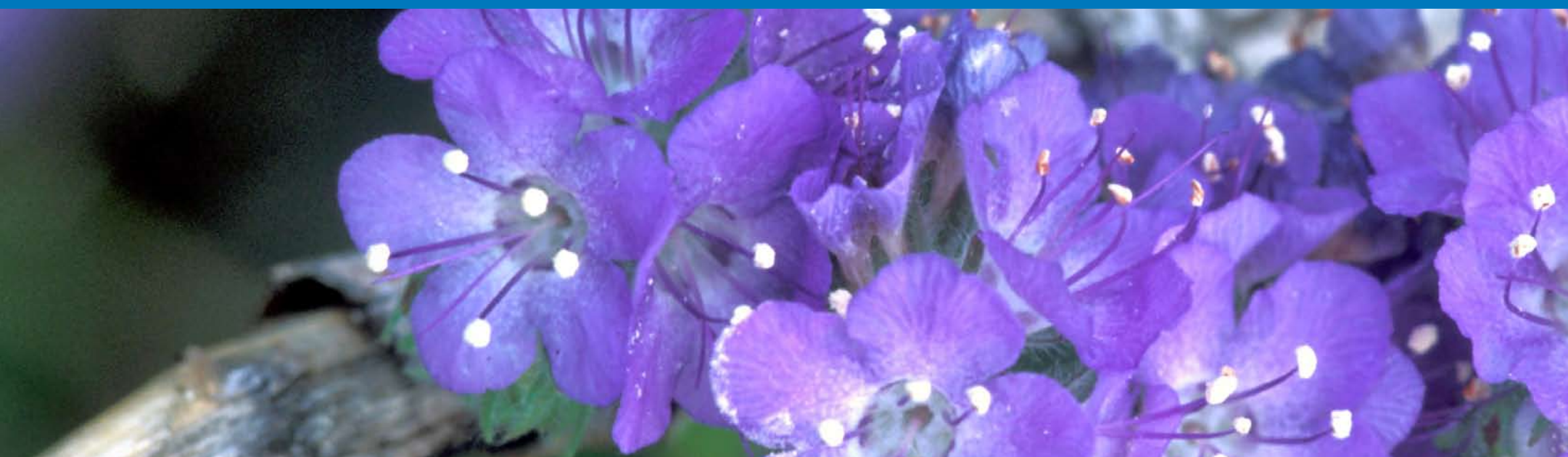

Imaging Postprocessing



» **IPS products** - efficient postprocessing devices by
IPS Imaging Postprocessing Solutions «

IPS - Our advantages

- Robust production systems, built for hard, continuous use over many years
- Low maintenance costs assure our machines are a safe and worthwhile investment
- Efficient and ergonomic design
- In house expertise for PLC logic and IT technology
- High quality standards to ensure high levels of performance and reliability
- Training and after sales service customized to individual needs
- Continuous development of the machines based on market feedback
- Modular based solutions
- Please contact us for any problem or idea you might have to increase the efficiency of your workflow - we would be pleased to discuss your specific requirements to define your customized solution

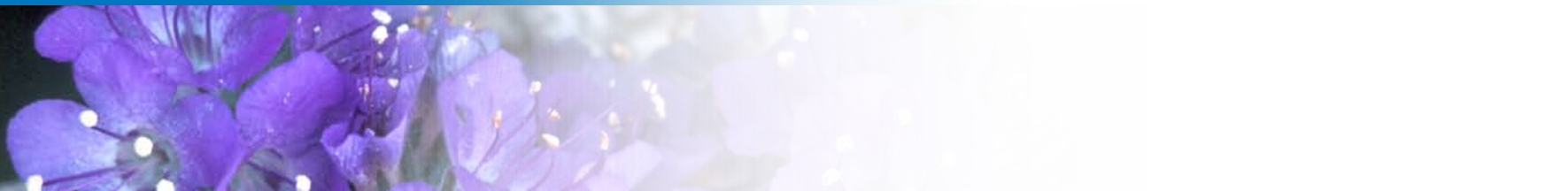
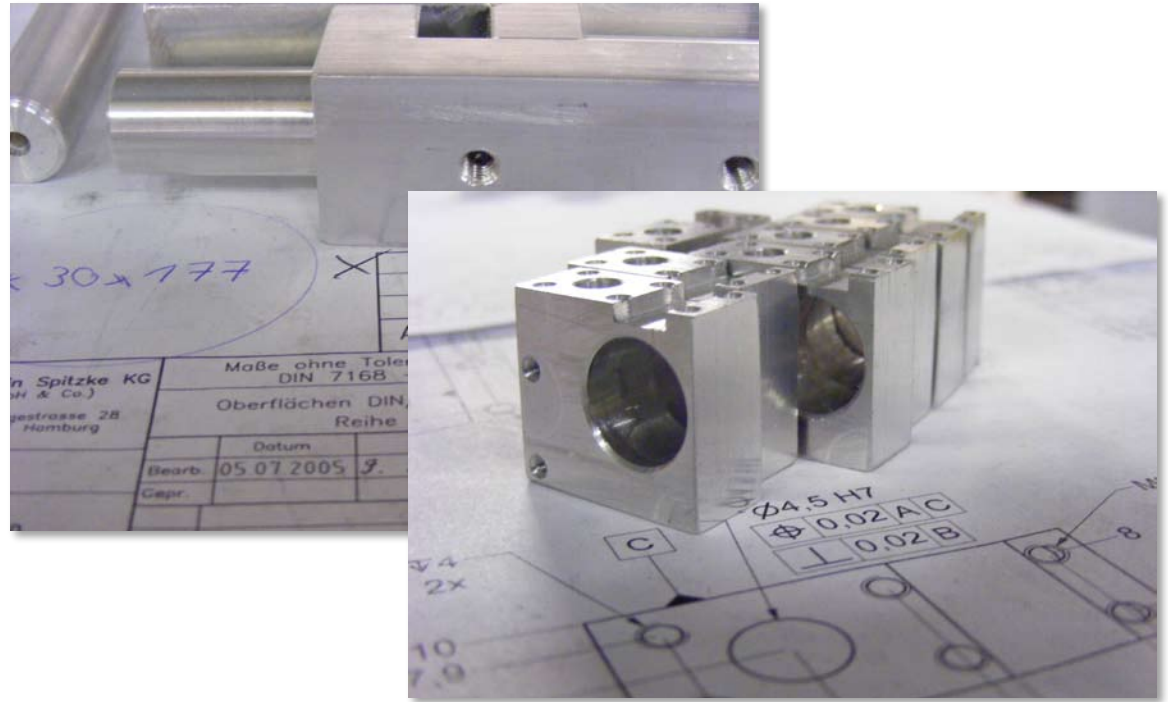

IPS – customized solutions

- Beyond the regular catalog equipment that is the foundation of our excellent reputation we also apply our deep understanding of our customer's business to our offerings of customized solutions in the postprocessing lab workflow
- For the past 60 years, we have proven our expertise to design and develop unique machine concepts
- State-of-the-art mechanical designs and problem solving techniques are combined with the full exploitation of sophisticated PLC and IT technologies
- Competence, reliability and our excellent after sales service justifies the confidence that our customers around the world show us every day



Panorama posters



Photo prints

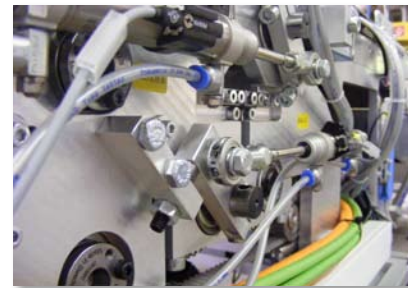

Photo posters



IPS – proven technology

- The state-of-the-art technology TwinCAT automation software provides a powerful high-speed I/O system that obsoletes the need for electronic boards
- 10 kbyte/ms, distributed to 1,500 devices
- No controller boards necessary
- No shut down time
- Touch screen technology supports ergonomic user interface
- Reliable with very long lifetime
- Low maintenance and repair costs
- Ethernet communication and PfDf –XML Interface
- Remote Access via TCP/IP protocol
- Daily utilization statistics
- Modular construction



Cutters

- Cutting prints from a roll and packaging in a bag is a fundamental function in the photofinishing workflow
- Our fastCut, wideCut and combiCut product lines provide high-speed cutting technology for standard and simultaneous cutting of multi-format orders
- Cutting speed saves operator time processing long digital orders and maintains the manual packaging effectiveness in workflows with fragmented batches and medium sized volumes
- Processing of large formats or mixed format orders are supported by the IPS wideCut or combiCut; you can cut and pack simultaneously all print formats in the customer order avoiding the cost of subsequent order component reconciliation

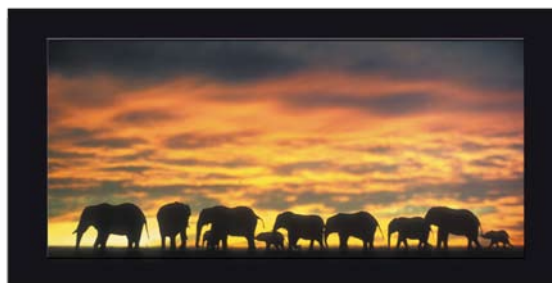

Panorama posters



Photo posters



Photo prints



Package prints

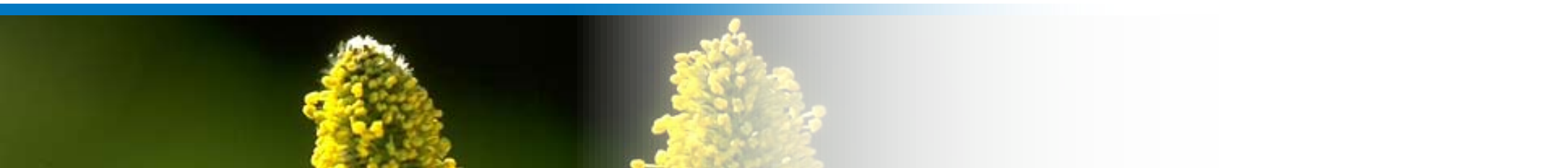

fastCut – key benefits

- fastCut increases the productivity in the postprocessing workflow
- Optimized for digital orders
- Cutting speed saves operator time processing long digital orders and maintains the packaging effectiveness
- Low downtime assures guarantees a stable productivity



fastCut – key features

High-speed solution for multi-format handling

- Hourly output capacity is up to 36,000 prints 10.2 x15.4 cm (4" x 6")
- Matched with performance of paper Processor VSP 50 fast print
- Simple and fast control with touch screen technology
- Designed to cut up to 12.7 cm (5") wide photo paper from rolls
- Cutting positions are marked with traditional punch marks
- Print sizes with variable length up to 20.3 cm (8") are handled
- With order ID print bi-check combined with full Pdf interface, eliminates the risk of mix-ups

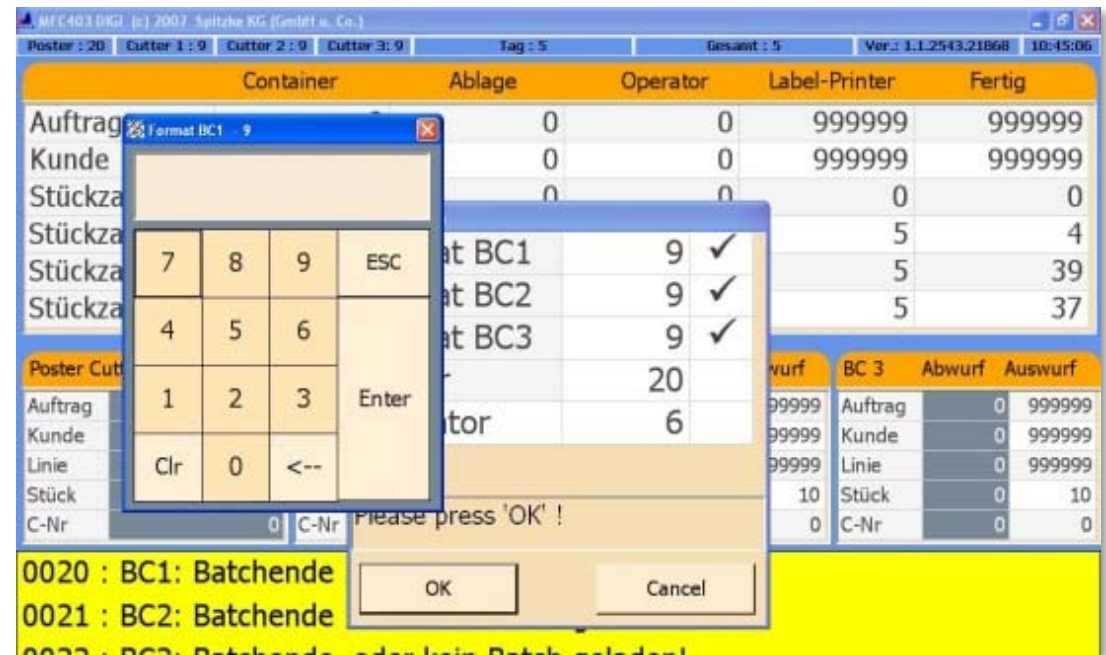

Touch screen technology supports ergonomic user interface

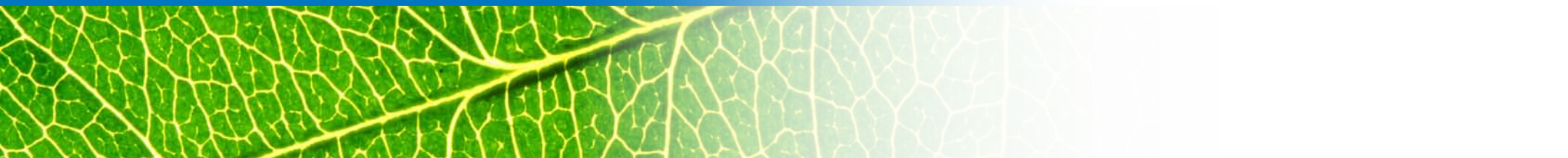

fastCut – key features

High-speed solution for optimized handling

- The remarkable output of up to 36,000 prints/h assures efficient production at true finishing speed
- Ergonomic user interface
- Reliable and long lifetime
- State-of-the-art technology
- Low maintenance and repair costs
- Stable productivity

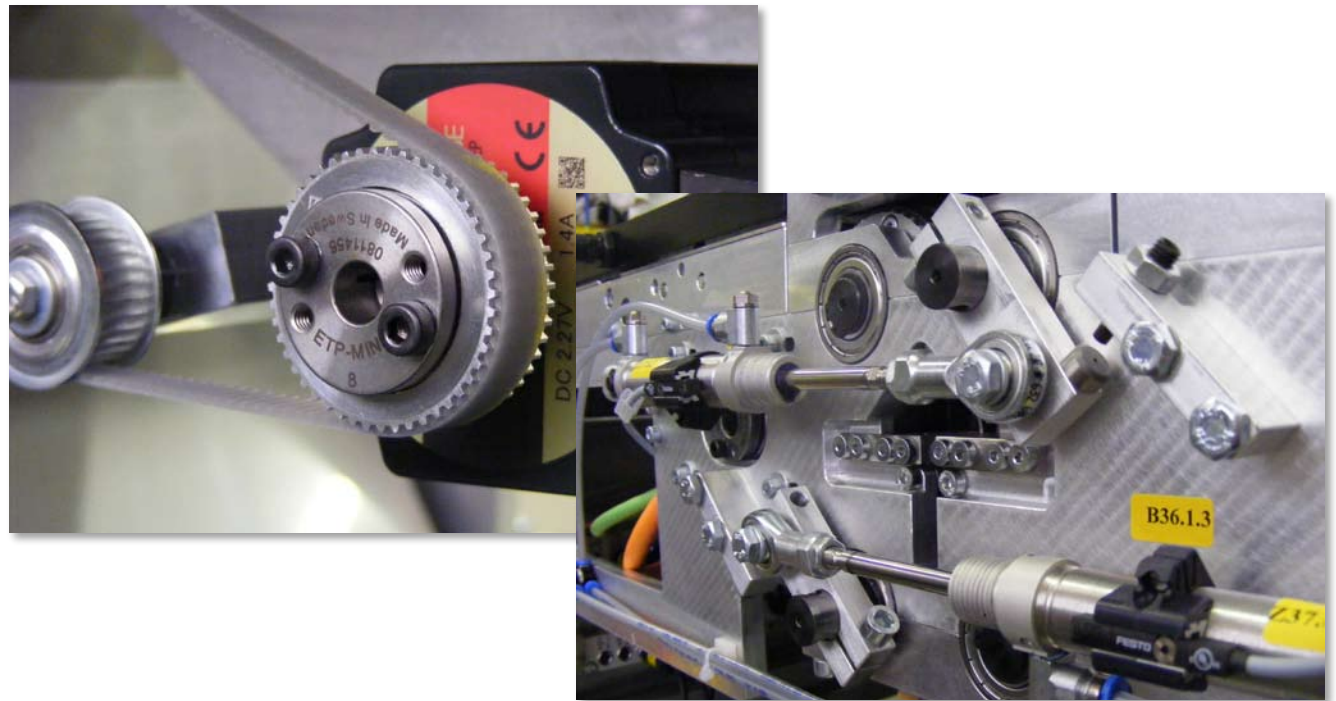

fastCut - technical details

Performance

- Cutter output
up to 36,000 prints per hour,
print size 10 x 15 cm (4" x 6")
- Print size standard
height : 8.9 – 12.7 cm (3.5"-5")
length: variable, max 20.3 cm (8")
- Data interface
PfDF, TCP/IP
- Compressed air
6 bar
- Power supply
380 V, 50-60 Hz
- Footprint 118 x 240 cm
(3.9 ft x 7.9 ft)
- IPS NLR (Noise Level Reduction)

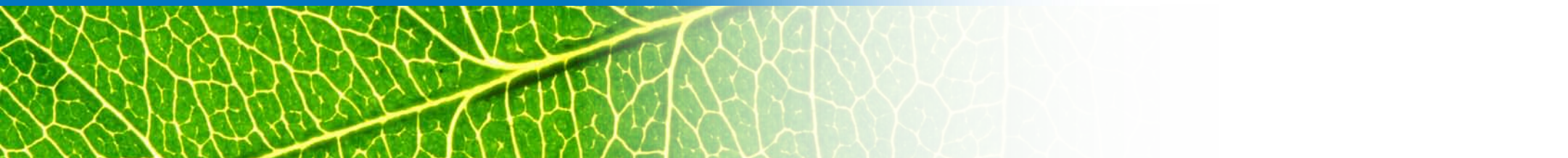

fastCut - overview

Proven technology

Based on years of experience

- In the traditional digital workflow images are exposed on the established high-speed printer fastPrint
- fastCut assures efficient cutting production at true finishing speed with the remarkable output of up to 36,000 prints/h
- Easy handling and operator supporting with print-conveyor

fastCut – technical data	
Cutting speed	Up to 36,000 cuts/h
Print size	Height: 9, 10, 11, 13 cm (3.5", 4", 4.5", 5") Length: variable max. 21 cm (3.5" up to 8")
Amount of cutters	Available as single cutter with and without conveyor
Twin and triple cutter for multi-format orders	Order plausibility check via order ID print
Host Interface	PfDf, TCP/IP
Optional	coupon feeder , barcode reader
Footprint	118 x 240 cm (3.9 ft x 7.9 ft)

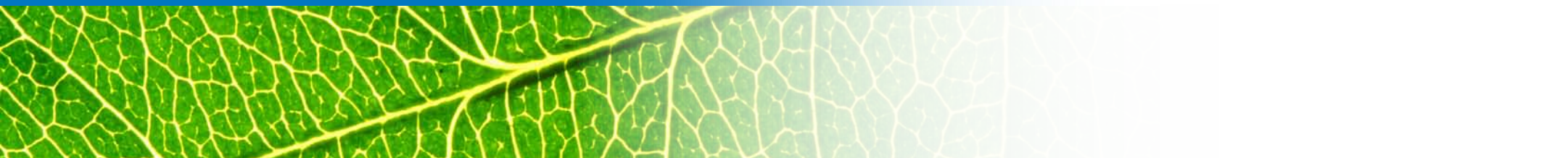

combiCut – key benefits

- combiCut improves the handling of multi-format print orders
- combiCut allows cutting up to four batch rolls simultaneously
- Multi-format orders can be handled in one operation at one station → saving operator time
- “order storage bin” collects the prints belonging to one order from each cutter and transfers them to the packing place where the operator can easily pack it
- Low maintenance assures a stable productivity



combiCut – key features

- Easy to operate
- Reliable machine function
- Designed to cut up to four batch rolls simultaneously
- Handling of variable print length within an order
- Order collecting bin presents the complete order to the operator
- PFDF interface
- Order plausibility check
- Options:
 - Handling of print sizes up to 20 x 30 cm (8" x 12")
 - Coupon feeder
 - Twin-cut feature

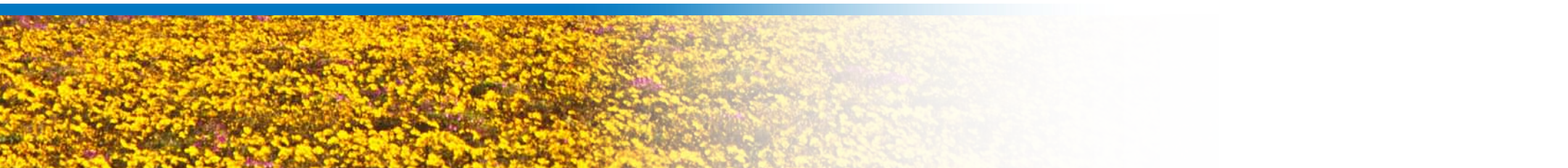
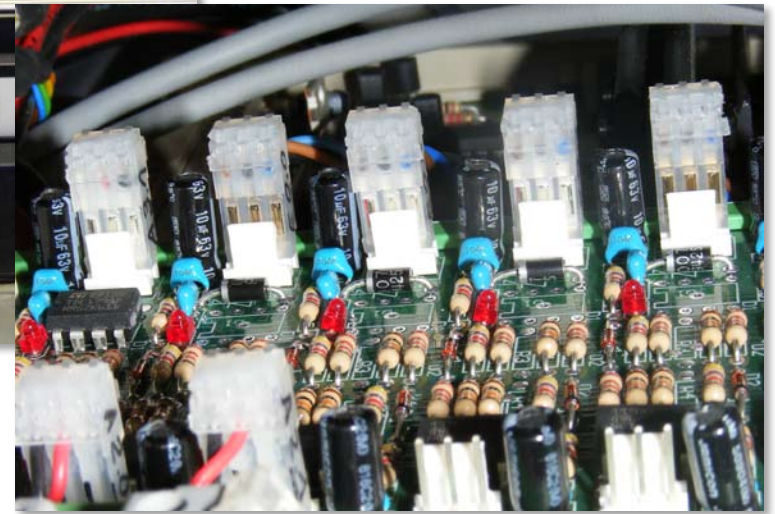
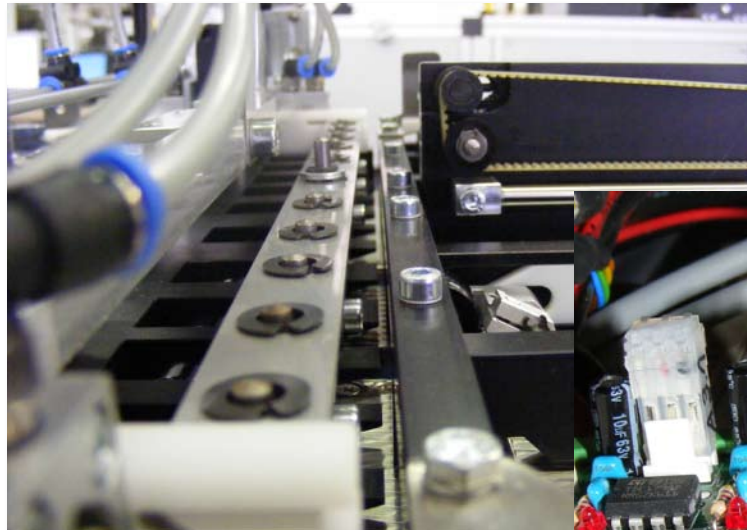

combiCut - technical details

Hardware

- Up to three 5" and one 12" cutters
- Output up to 36,000 prints/h in size 10.2 x 15 cm (4" x 6")
- Print size standard
height: 8.9 to 30.5 cm (3.5" to 12")
length: variable, max. 45.7 cm (18")
- Data interface
PfDF, TCP/IP
- Compressed air
6 bar
- Power supply
380 V, 50-60 Hz
- IPS NLR (Noise Level Reduction)

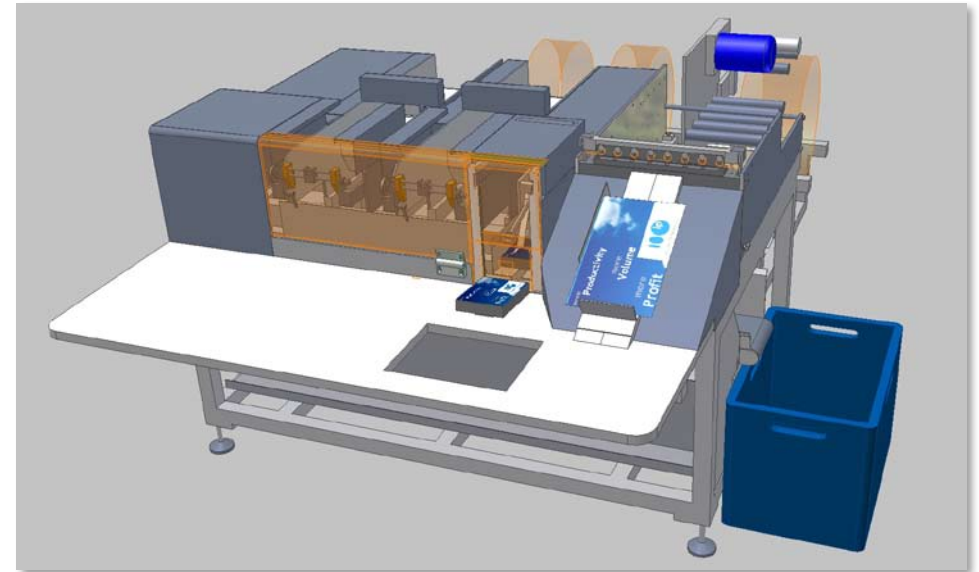

combiCut - overview

Optimized handling of mixed format orders

- combiCut improves the handling of multi-format print orders
- combiCut is capable of cutting up to four batch rolls simultaneously
- Multi-format orders can be handled in one operation at one station, saving operator time
- "Order storage bin" collects the prints, belonging to one order, from each cutter and transfers them to the packing place where the operator can easily pack it
- Low maintenance assures a stable productivity

combiCut – technical data	
Print size	min. 7.6 x 10.2 cm (3" x 4") max. 30.5 cm x 76.2 cm (12" x 30")
Amount of cutters	Up to three 5" cutters and one 12" cutter
Cutting positions	punch-marks
Host Interface	PfDf, TCP/IP
Order plausibility check	bi-check - prints and order envelope, OrderIdentPrint
Footprint	240 x 190 cm (7.9 ft x 6.2 ft)

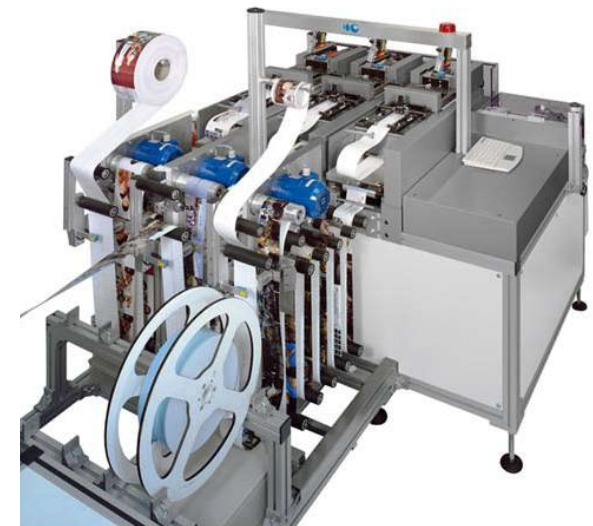

wideCut - overview

Poster Cutter up to 12"

- wideCut is able to cut prints from 5" up to 12"
- wideCut is available as x/y cutter, so it may be used to cut mixed-orders printed together on an 8" paper roll
- For an optimized order handling an optional print conveyor is available on wideCut
- Even a combination and connecting of different machines is possible to fit the solicitation of the lab specific workflow

wideCut – technical data	
Xcutter max print size	12" by 30" (30,4 x 76,2 cm)
Xcutter output	7.200 prints/h - Format: 20 x 30 (8" by 12")
XYcutter option	7.000 prints/h - Format: 30.4 x 30.4 (12" by 12")
Minimum print size	12.7 x 12.7 cm (5" x 5")
Cutting positions	traditional punch-marks - exposed optical marks
Host Interface	PfDf, TCP/IP
Order plausibility check	bi-check - prints and order envelope
Footprint	248.5 x 110 cm (8.2 ft x 3.6 ft)

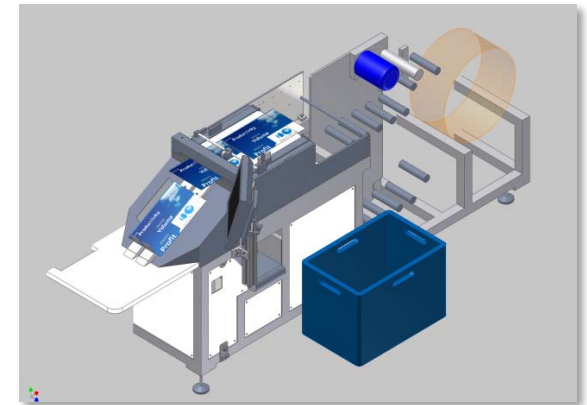

Packaging Solutions

- Combining our cutting technology with automatic packaging provides high productivity when compared with manual packing - the stability of our automatic production line allows one operator to control several units simultaneously
- The modular design of our packaging machines allows different combinations and many optional features to configure the equipment properly for your individual requirements
- Different machines may be connected and combined to fit the requirements of the lab specific workflow

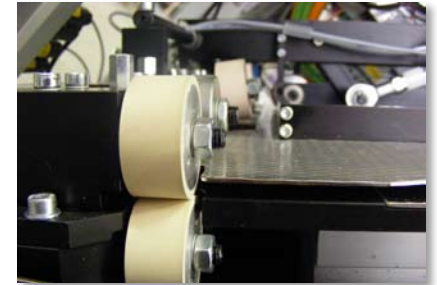
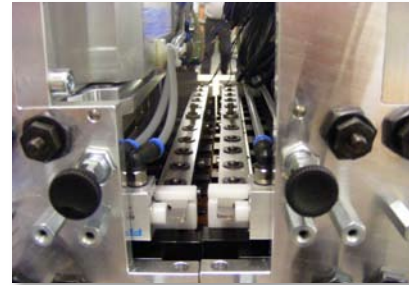
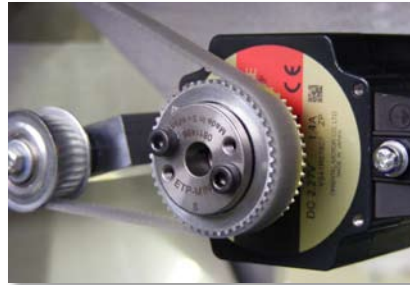

fastPack – key benefits

- The combination of our cutting technology with automatic packaging provides high productivity
- High stability allows that one operator can operate several units simultaneously
- Investment in the most labor intensive segment in the workflow improves cost production competitiveness
- Modular design provides adaptation to lab specific workflow
- The modular design enables an easy adaptation of the machine to lab specific workflow
- fastPack features all requirements needed to handle digital orders, even the handling of big digital orders
- Equipped with two print cutters the fastPack can handle orders containing two print sizes
- Order plausibility check can to be done via order ID print (OIP)

Variant: for mail order lab

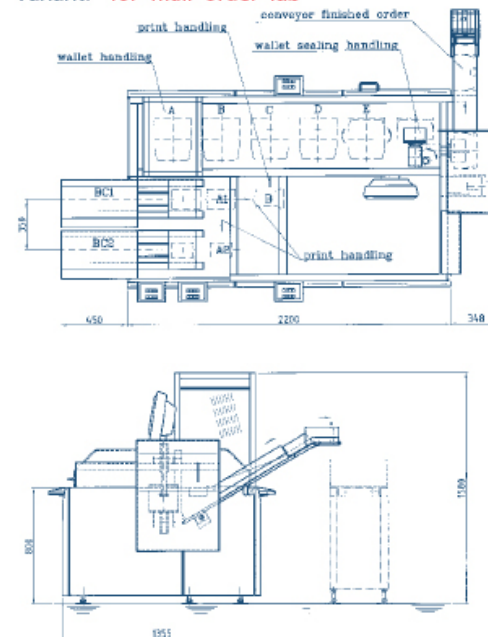

fastPack - overview

Proven technology

Based on years of experience

- In the traditional digital workflow images are exposed on the established high-speed printer fastPrint
- fastPack assures an efficient cutting production at true finishing speed with the remarkable output of up to 36,000 prints/h
- Easy handling and operator supporting with print-conveyor

fastPack – technical data	
Cycle time	about 4 sec/package
Basic Equipment	5" Cutter Wallet packaging and sealing
Equipment options	Second print cutter Coupons, CD feeder etc.
Print size	Width: 9/10/11/13 cm (3.5/4/4.5/5") Length: from 9 up to 22.9 cm (3.5" up to 9")
Wallet/eurocombi size	Width: up to 15.3 cm (6") Length: from 19 to 27.9 cm (7.5" up to 11")
Bag size	Width: 15.3 up to 17.8 cm (6" up to 7") Length: about 29 cm (11.4")
Order plausibility check	batch file and punch mark or OIP Multi way matching when required
Data interface	PDFD –TCP/IP



fastMail - overview

Automatic mail envelope packaging unit

fastMail combines :

- Mailorder packaging
- Invoice/delivery note in line production
- Weighing for postage charge calculation
- Postage and address label application

fastMail - technical data	
Productivity	up to 900 mail-envelope/hour
Mail-envelope	Dimensions: 23.8 x 32.5 x 8.3 cm Thickness: cardboard
Invoice handling	On line laser printing - Size A3 - Folding and discharge
Address & Postage	Automatic postage calculation Label size: 10,4 X 16cm
Host Interface	PfDf, TCP/IP
Bag size	Width: 15.3 up to 17.8 cm (6" up to 7") Length: about 29 cm (11.4")
Plausibility check	Invoice – bag
Footprint	188.5 x 379.5 cm



fastSort - overview

Benefits

System to sort orders for tours or zip-codes

- e.g. 17 drops
- min 5 drops
- Expandable module manner
- Each module 6 units
- Stand-alone or connected with fastcollect & fastpack
- Handling of thick orders (until 6 single envelopes in the order)
- Handling of A4 flat-pack
- scanning the order-number
- transfer of data at the BMS Sorting into containers

fastSort - technical data	
Speed	Up to 30 packages/min
Data interface	cvs Data PDF, TCP/IP
Footprint	380 x 300 cm (12.5ft x 9.8ft)
Height/weight	90 cm (3ft)/about 600kg
Compressed air	6 bar
Power supply	380 V / 50-60 Hz

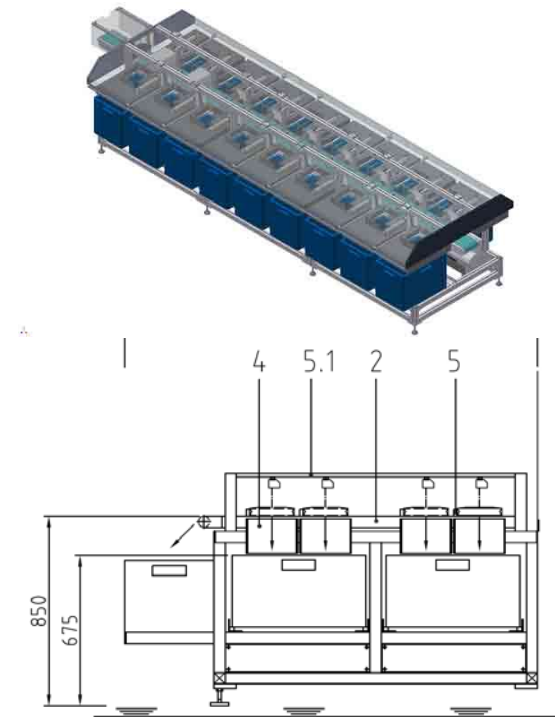

IS / IPS Product Portfolio – complete workflow solutions with hardware and software

Input



Efficient processing of analog and digital input from film, CD, memory sticks etc

- fastScan
- reScan
- fastEntry

Software



Industry-leading image enhancement software and workflow systems for easy implementation, and frontend solutions without click rate

- netGate
- PURUS
- VIESUS™
- photoClient

Output



Fastest digital printers worldwide exposing up to 20,000 prints per hour from 8.9 - 30.5 cm (3.5"-12")

- fastPrint 8
- fastPrint 12
- fastPrint 20
- widePrint 8"
- widePrint 12"

Processing



High-performance paper processor with optimal integration both to analog and digital workflow

- paperProcessor VSP 25-12
- paperProcessor VSP 50

Post-Processing



Advanced systems for production of book blocks for purePhoto™ books and for cutting, packing and sorting

- fastBook
- fastCCF, fastCut*
- wideCut, combiCut*
- fastPack, fastMail*

*manufactured by Imaging Postprocessing Solutions, Germany

IS & IPS - your system partners



SWISS MADE MADE IN GERMANY





ImagingPostprocessing

Imaging Postprocessing Solutions has a high expertise in development and production of postprocessing devices designed to specific requirements.

Efftingestrasse 28
D-22041 Hamburg

**Imaging Postprocessing
Solutions GmbH**

sales@imagingpostprocessing.com
www.imagingpostprocessing.com

Germany

Tel. +49 40 656 90 40
Fax +49 40 656 36 56

A subsidiary of
Imaging Solutions AG,
Switzerland

Althardstrasse 70
CH-8105 Regensdorf

**Imaging Solutions AG
Sales & Marketing**

sales@imagingsolutions.ch
www.imagingsolutions.ch

Switzerland

Tel. +41 44 842 21 21
Fax +41 44 842 21 42